

OFFICE NEWS



Yaggy Colby Associates has received a 2009 Honor Award from the American Consulting Engineers Council (ACEC) of Minnesota for the Peace Plaza in downtown Rochester, Minnesota. The firm was the lead Designer for the \$2 million project constructed in the Spring of 2007.

LEED® AP STAFF GROWS TO NINE

Yaggy Colby Associates is pleased to announce the designation of six more individuals in the firm as Leadership in Energy and Environmental Design Accredited Professionals (LEED® AP). This brings the rapidly growing total of firm wide accreditations to nine. Our sustainability team includes:

Jose Rivas, AIA, LEED® AP
Jason Woodhouse, AIA, LEED® AP
Shayn Jensson, LEED® AP
Alyssa Fordham, LEED® AP
Wade Goss, LEED® AP
James Theobald, LEED® AP
Heather McGuire, ASLA, LEED® AP
Jeffrey Klamik, PE, LEED® AP
Christa Wollenzien, ASLA, LEED® AP



Hadley Creek, a master planned community built around a nine-hole golf course in northeast Rochester, Minnesota has received an Olmsted County/RPU 2009 Environmental Achievement Award.

This award is given to individuals, organizations, or business who have made a significant contribution to environmental quality in Olmsted County. Hadley Valley Partners is the client that accepted this award.

2009 WSLs AWARDS

The firm's Delafield office recently won three spots in the Wisconsin Surveyor's Institute competition. 2nd Place in Final Plats, 2nd Place in Plat of Surveys, and 3rd Place in Topographic Surveys.

CONGRATULATIONS...

Mark Haselius (R) passed his Land Survey Exam. He is now a Licensed Land Surveyor.

Jason Eckart (D), and **Jason Havel (R)** have passed their Professional Engineering exams and are now licensed Engineers.

HIGHLIGHTS FEBRUARY 2009

Published quarterly for Yaggy Colby Associates' clients and friends. For information, contact:

Robert L. Ellis bellis@yaggy.com	President, COO
Scott V. Samuelson, PE ssamuels@yaggy.com	CFO
Michael P. Court, PE mikec@yaggy.com	Vice President
Terrance J. McCarthy tmccarth@yaggy.com	Vice President
Jose L. Rivas, AIA, NCARB jrivas@yaggy.com	Secretary
Christopher W. Colby, AIA, CID ccolby@yaggy.com	Principal
Mark Mickelson, PE markm@yaggy.com	Principal

Rochester: 717 Third Avenue SE
Rochester, MN 55904
(507) 288-6464 (507) 288-5058 FAX

Minneapolis / St. Paul: 2020 Silver Bell Road, Suite 4
Eagan, MN 55122
(651) 681-9040 (651) 905-3707 FAX

Mason City: 215 North Adams
Mason City, IA 50401
(641) 424-6344 (641) 424-0351 FAX

Milwaukee: PO Box 180500
Delafield, WI 53018
(262) 646-6855 (262) 646-6864 FAX

Editor: Tammy S. Westby Marketing /Business
twestby@yaggy.com Development

Join us on the web located at: www.yaggy.com
The site includes an overview of the firm and its services. Current projects, site photographs, and employment opportunities are also presented.

SUSTAINABLE SITE DESIGN SERVICES



Doesn't it seem like the headlines have all gone "green"? We see, hear, and read about it throughout mainstream media. The push to go green is also gaining momentum in the building industry, particularly with regard to building products and techniques. However, little attention is paid to the role site design plays in improving overall energy efficiency of the development.

A host of interconnected variables including site topography, vegetation, solar access and wind patterns can affect how a site functions. Understanding these variables and considering them in the design can reduce construction costs and increase operating energy efficiency, which in turn adds value to your development. Yaggy Colby Associates provides expertise in site assessment, design and engineering to maximize your potential investment.

The first step in unlocking your site's potential is site assessment. The firm's landscape architects, surveyors, geotechnical engineers and environmental specialists can compose a thorough assessment and inventory of your site's attributes.

Based on the site assessment, our landscape architects and planners will use the site's natural features to maximize the efficiency and sustainability of your project. A building designed with passive solar attributes uses roughly 47% less energy than a conventionally designed building. To take advantage of passive solar gain, it's critical to consider solar access during the site design process. In addition, existing vegetation such as a stand of trees can also reduce energy consumption by limiting winter wind exposure and providing summer shade.

Yaggy Colby Associates' engineers also strive to reduce energy consumption and project costs. Construction costs associated with grading, tree clearing, erosion control and utility construction can be minimized with careful site design and placement of site features. In addition, the use of innovative stormwater techniques can reduce infrastructure costs, increase a site's usable area, improve water quality and reduce runoff.

(Continued on page 2)

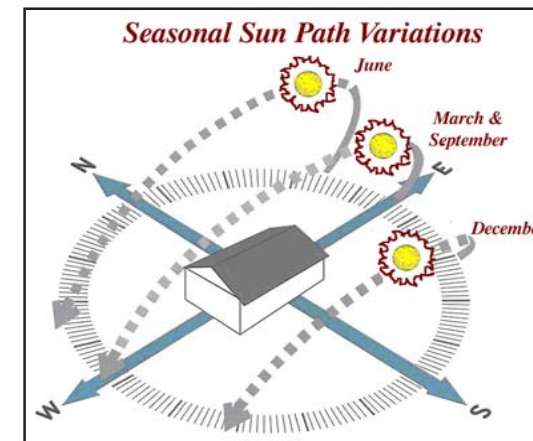

ENGINEERS

ARCHITECTS

LANDSCAPE ARCHITECTS

SURVEYORS

PLANNERS

FEBRUARY 2009

IN THIS ISSUE

Page 1

- Sustainable Site Design Services

Page 2

- Iowa CREP Program Provides Incentives
- Sustainable Site Design Services (continued)
- New Projects

Page 3

- 55th Street Extension Preliminary Design
- French Island Welcome Center

Page 4

- Office News

717 Third Avenue Southeast
Rochester, MN 55904



PRESORTED
STANDARD
US POSTAGE PAID
ROCHESTER MN
PERMIT NO. 4

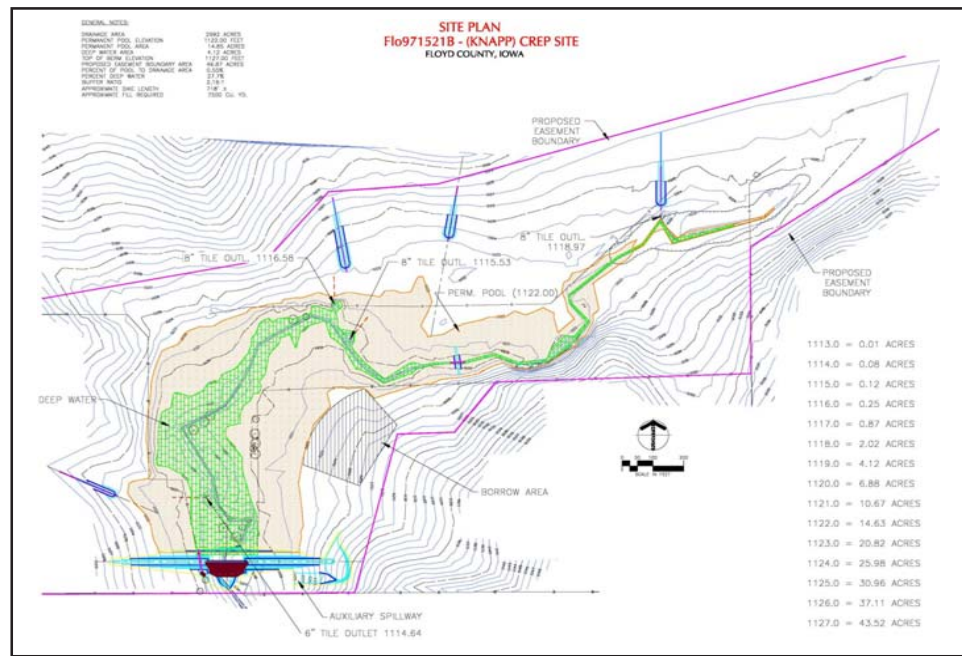

CREP PROGRAM PROVIDES INCENTIVES

The Iowa Conservation Reserve Enhancement Program (CREP) provides incentives to land owners who voluntarily establish wetlands for water quality enhancement in a 37-county area in Iowa. The goal of the program is to reduce nitrogen loads and movement of other agricultural chemicals from croplands to streams and rivers.

Yaggy Colby has been involved in the program since 2004 providing design services on sixteen sites to date. These services include topographic and boundary surveys, grading and drainage structure design, and construction staking, observation and administration.

During this time the firm has established a strong working relationship with the staff at the Iowa Department of Agriculture and Land Stewardship. This is reinforced by the Department's engineer Mr. Mike Bourland, PE who states, "Yaggy Colby has worked well with all entities involved in this process. Our agency has appreciated their professional approach, completing projects on time and within budget."

The firm was recently selected to provide design services on a special demonstration site in Marshall County, Iowa. This project will provide interested contractors insight on the construction methods utilized for these projects.

SUSTAINABLE DESIGN - (Continued from page 1)

Our accomplished sustainability team includes nine Leadership in Energy and Environmental Design Accredited Professionals (LEED® AP).

Each LEED® AP has passed the accreditation exam administered by the U.S. Green Building Council. This designation demonstrates technical competence with regard to green building practices and principles,

as well as LEED® requirements, resources, and processes.

While we have summarized a few variables that can contribute to a development's efficiency, each site is unique. Yaggy Colby Associates will work as a member of your design team and evaluate which design measures would achieve your specific green goals.

NEW PROJECTS

MINNESOTA

Gift of Life Transplant House
Rochester, Minnesota

Our Savior's Lutheran Church
Eyota, Minnesota

Wagon Wheel Trail - Phase I
La Crescent, Minnesota

Garvin Brook/Lake Goodview
Goodview, Minnesota

Rest Area Siting Study
Adair/Jasper County Iowa

TH 55 Mill & Overlay
Rosemount, Minnesota

TH 58 Preliminary Design
Zumbrota, Minnesota

2009 CIP

Stewartville, Minnesota

Eastwood Bank
Rochester, Minnesota

IOWA

New Water Treatment Plant
Floyd, Iowa

Iowa Dept of Agriculture & Land Stewardship - CREP
Marshall County, Iowa

LMCDC

Safe Routes to Schools
Phase I Project
Lake Mills, Iowa

Menards Expansion
Des Moines, Iowa

Winnebago River Levee Improvement - Phase III
Mason City, Iowa

WISCONSIN

Fairmount Avenue
Utility & Street Reconstruction
Village of Whitefish Bay

Lake Drive Water Main Relay
Village of Whitefish Bay

Bark River Floodplain Study
Summit, Delafield, Hartland, and Waukesha County, Wisconsin

Campus Drive Connector
Village of Hartland

55TH STREET EXTENSION PRELIMINARY DESIGN NEARS COMPLETION

Yaggy Colby is currently working with Olmsted County to complete the preliminary design and environmental documentation for the \$17 M 55th Street Extension Project that will extend 55th Street across the South Fork Zumbro River to intersect with State Highway 63 in northeast Rochester, Minnesota.

The project scope for this federally funded project was modified in 2008, adding the preliminary design and environment documentation of 1.3 miles of State Highway 63 at the east end of the 55th Street Extension Project. Eleven alternate designs were identified and analyzed, and two alternates have been considered for State Highway 63.

Preferred alternates have been identified for each roadway, and a detailed

environmental and design analysis is being conducted for both parts of the project. The project which is close to 75% complete includes a geometric layout,

environmental assessment, hydraulic studies, traffic studies, preliminary bridge design, utility and environmental agency coordination, public involvement and location and design surveys.

Project challenges include coordinating with an ongoing access management



study on Highway 63, impacts to an operating gravel mining site, coordination with the city to minimize the impacts to Essex Park and coordination with an ongoing Federal Emergency Management Agency (FEMA) study of

Hadley Creek. This phase of the project is scheduled for completion in early 2009, so final design can begin. Construction is planned to start in 2010. This urban arterial connection and river crossing will enhance east-west traffic flow in north Rochester and Olmsted County, provide system connectivity, and ensure public safety while responding to growing travel demands.

Yaggy Colby Associates is proud to have a part in this high profile project. We are sure that the completed project will improve the transportation system in this part of Olmsted County.



FRENCH ISLAND WELCOME CENTER

Yaggy Colby Associates was formally awarded the design of a new Welcome Center and Safety Rest Area for the Wisconsin DOT at French Island, near La Crosse, Wisconsin. The project located along I-90 will incorporate water conservation and sustainable design practices as a theme to be carried throughout the site and building design.

Preliminary plans developed for the design selection competition include features such as harvesting of rainwater for toilet flushing and irrigation, containment of storm

water runoff, use of passive and active solar energy, and visually linking the building and its surroundings to the scenic French Slew natural habitat.

According to Principal Architect, Jose Rivas, AIA, LEED® AP, "This project will not only follow sustainable design principles, but will be the first rest area project designed by the firm seeking LEED® Certification." The entire team at Yaggy Colby Associates is excited about applying our 15 year plus experience in the design of Interstate Rest Areas.

